

PATTERN  
BROUGHT  
TO YOU BY:

# Quilts & more™

[allpeoplequilt.com](http://allpeoplequilt.com)

---

## PROJECT: Stylish Pot Holder

---

Piece a pot holder that will add color to your kitchen.

INSPIRED BY: *Treasure Trove* from designer Vicki Ruebel of Orchid Owl Quilts ([orchidowlquilts.com](http://orchidowlquilts.com))

PROJECT TESTER: Sarah Huechteman



**FABRICS** are from the Ink Flowers collection by Ninola Designs for P&B Textiles ([pbtex.com](http://pbtex.com)).

## PROJECT: Stylish Pot Holder

### POT HOLDER

Finished size: 9½" square

Finished block: 9½" square

### MATERIALS

Yardages and cutting instructions are based on 42" of usable fabric width.

- 14"-square pink print (block, backing)
- 12"-square light yellow print (block)
- 8"-square blue print (block)
- ¼ yard fuchsia print (block, binding)
- 3½"-square dark yellow print (block)
- 9½"-square cotton batting
- 9½"-square insulated batting, such as Insul-Bright

### CUT FABRICS

Cut pieces in the following order.

#### From pink print, cut:

- 1—9½" backing square
- 4—2" squares

#### From light yellow print, cut:

- 4—2×3½" rectangles
- 4—2×3" rectangles

#### From blue print, cut:

- 2—3½×4½" rectangles

#### From fuchsia print, cut:

- 1—2½×42" binding strip
- 1—2×5" strip
- 4—2×3½" rectangles

### ASSEMBLE BLOCK

Measurements include ¼" seam allowances. Sew with right sides together unless otherwise stated.

Press seams in directions indicated by arrows on diagrams. If no direction is specified, press seam toward darker fabric.

- 1) Referring to **Diagram 1**, sew together a pink print 2" square and a light yellow print 2×3" rectangle to make a subunit. The unit should be 2×4½" including seam allowances. Repeat to make four units total.
- 2) Referring to **Diagram 2** for placement of pink print squares, join two subunits to make a unit. The unit should be 3½×4½" including seam allowances. Repeat to make a second unit.
- 3) Turn a unit wrong side up. Referring to **Diagram 3**, use an acrylic ruler and pencil to mark two diagonal lines. (To prevent fabric from stretching as you draw lines, place 220-grit sandpaper under the unit.) Repeat to mark the second unit.
- 4) Layer a marked unit atop a blue print 3½×4½" rectangle. Sew together on marked lines (**Diagram 4**). Trim ¼" outside each sewn line (**Diagram 5**). Press open attached triangles to make two pieced triangle-squares. Each pieced triangle-square should be 3½" square including seam allowances. Repeat to make four pieced triangle-squares total.
- 5) Sew together a light yellow print 2×3½" rectangle and a fuchsia print 2×3" rectangle to make a rectangle unit (**Diagram 6**). The unit should be 3½" square including seam allowances. Repeat to make four rectangle units total.
- 6) Referring to **Diagram 7**, join two pieced triangle-squares and one rectangle unit in a row. The row should be 3½×9½" including seam allowances. Repeat to make a second row.
- 7) Join dark yellow print 3½" square and remaining rectangle units to make a middle row (**Diagram 8**). The row should be 3½×9½" including seam allowances.
- 8) Join Step 6 rows to middle row to make a block (**Diagram 9**). The block should be 9½" square including seam allowances.

### ASSEMBLE POT HOLDER

- 1) Place pink print 9½" backing square right side down. Top with insulated batting 9½" square, cotton batting 9½" square, and block right side up. Baste layers together.
- 2) Quilt as desired. Project tester Sarah Huechteman stitched in the ditch around the individual pieces.
- 3) With wrong side inside, fold fuchsia print 2×5" strip in half lengthwise (**Diagram 10**). Lightly press; unfold. Fold long raw edges in to meet at center. Fold at center, hiding raw edges and aligning folded edges; press again. Edgestitch double-folded edge.
- 4) Matching raw ends, fold Step 3 unit in half to make a loop. Referring to **Diagram 11**, pin raw edges of loop centered on a back edge.
- 5) Bind with fuchsia print binding strip, catching the loop edges in the stitching, to complete pot holder.

PATTERN  
BROUGHT  
TO YOU BY:

# Quilts & more™

allpeoplequilt.com

## PROJECT: Stylish Pot Holder

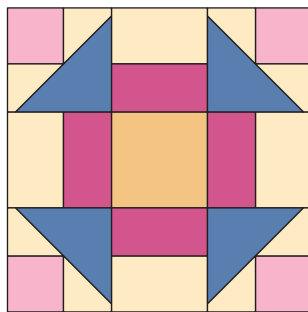
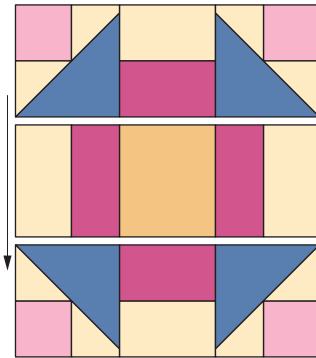
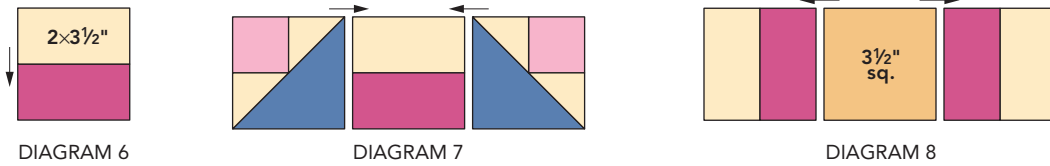
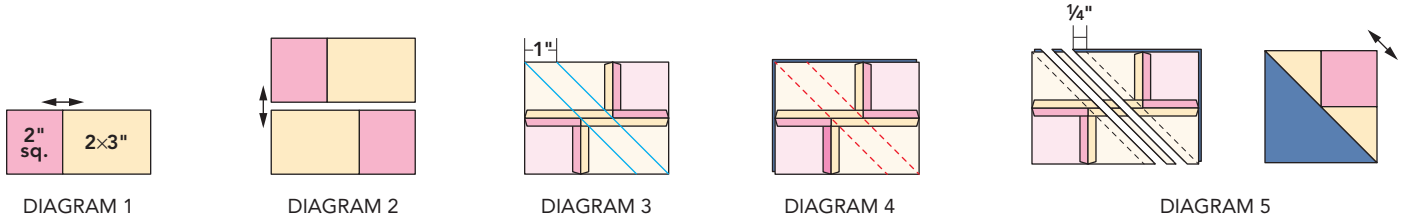

DIAGRAM 9

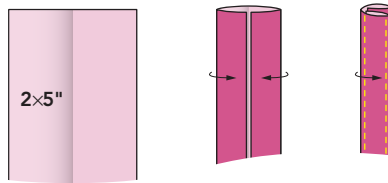

DIAGRAM 10

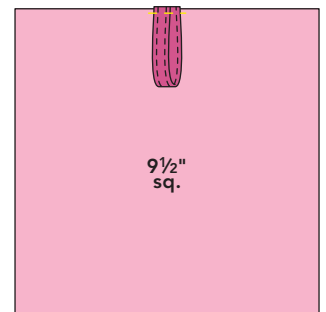

DIAGRAM 11