

PROJECT: Ocean Oasis Pillow
Punchy teals, blues, and greens remind us
of days at the beach.

INSPIRED BY: *Warm Reception* from designer Rebecca Lidstrom of
Studio R Quilts (studiorquilts.com)

QUILT TESTER: Martha Gamm



FABRICS are from the Dance in Paris collection by Zen Chic for Moda Fabrics (modafabrics.com).

PILLOW

Finished size: 18" square
Finished block: 18" square

MATERIALS

Yardages and cutting instructions are based on 42" of usable fabric width.

- ❑ ½ yard total assorted teal prints (pillow top)
- ❑ Scraps of assorted white prints (pillow top)
- ❑ ¾ yard total assorted navy prints (pillow top)
- ❑ ⅝ yard lime green print (pillow top, backing)
- ❑ Scraps of assorted green prints (pillow top)
- ❑ 18½"-square batting
- ❑ 18½"-square muslin
- ❑ 18"-square pillow form

CUT FABRICS

Cut pieces in the following order.

If you prefer to make triangle-squares larger than necessary and then trim them to size, cut 7" squares instead of the 6⅞" squares specified in the cutting instructions.

From one teal print, cut:

- 2—6⅞" squares

From assorted teal prints, cut:

- 4—3½×6½" rectangles

From assorted white prints, cut:

- 8—3½" squares

From assorted navy prints, cut:

- 1—6½" square
- 8—3½" squares

From lime green print, cut:

- 2—11¾×18½" rectangles
- 2—6⅞" squares

From assorted green prints, cut:

- 4—3½×6½" rectangles

ASSEMBLE PILLOW TOP

Measurements include ¼" seam allowances. Sew with right sides together unless otherwise stated.

Press seams in directions indicated by arrows on diagrams. If no direction is specified, press seam toward darker fabric.

- 1) Use a pencil to mark a diagonal line on wrong side of each teal print 6⅞" square, each white print 3½" square, and each navy print 3½" square. (To prevent fabric from stretching as you draw lines, place 220-grit sandpaper under each square.)
- 2) Layer a marked teal print 6⅞" square atop a lime green print 6⅞" square. Sew together with two seams, stitching ¼" on each side of drawn line (**Diagram 1**). Cut pair apart on drawn line. Press open to make two triangle-squares. Each triangle-square should be 6½" square including seam allowances. Repeat to make four triangle-squares total.
- 3) Align a marked white print 3½" square with left-hand end of a teal print 3½×6½" rectangle (**Diagram 2**; note direction of marked line). Sew on marked line. Trim seam allowance to ¼". Press open attached triangle. Add a second marked white print 3½" square to right-hand end of rectangle to make a white Flying Geese unit. The unit still should be 3½×6½" including seam allowances. Repeat to make four white Flying Geese units total.
- 4) Repeat Step 4 using marked navy print 3½" squares and green print 3½×6½" rectangles to make four navy Flying Geese units.

- 5) Sew together a white Flying Geese unit and a navy Flying Geese unit to make a side unit (**Diagram 3**). The unit should be 6½" square including seam allowances. Repeat to make four side units total.
- 6) Referring to **Pillow Top Assembly Diagram** and noting orientation of triangle-squares, lay out triangle-squares, side units, and navy print 6½" square in three rows. Sew together pieces in rows. Join rows to make pillow top. The pillow top should be 18½" square including seam allowances.

FINISH PILLOW

- 1) Layer pillow top, batting square, and muslin square. Quilt as desired.
- 2) Turn one long edge of each lime green print 11¾×18½" rectangle under ¼"; press. Turn under ¼" again. Stitch in place to make hemmed pillow back pieces. Each hemmed pillow back piece should be 11¾×18½" including seam allowances.
- 3) Referring to **Pillow Back Assembly Diagram**, overlap hemmed edges of pillow back pieces by 4" to make an 18½" square. Stitch across overlaps to make pillow back.
- 4) Layer pillow top and pillow back with right sides together. Stitch ¼" from outer edges to make pillow cover. Turn right side out through opening in pillow back; press.
- 5) Insert pillow form through opening to complete pillow.

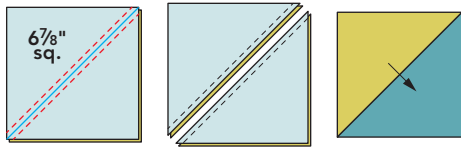

DIAGRAM 1

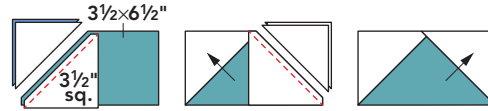
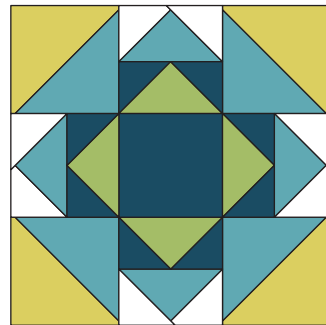
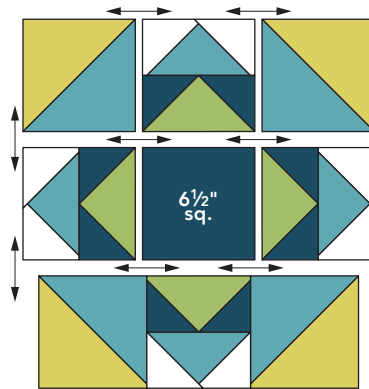

DIAGRAM 2



PILLOW TOP ASSEMBLY DIAGRAM

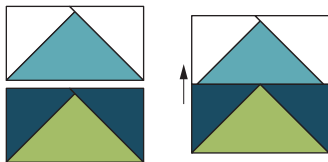
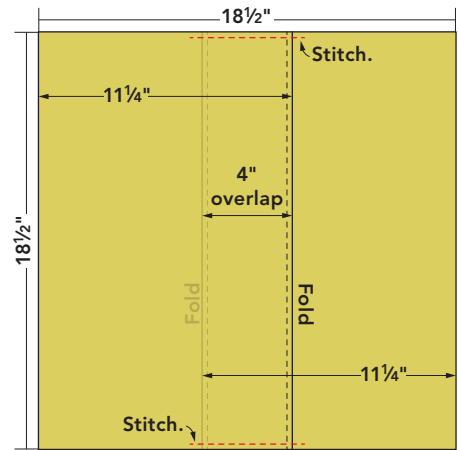

DIAGRAM 3



PILLOW BACK ASSEMBLY DIAGRAM