

Project: Mystery Row Quilt: Row 6 and Finishing Instructions

DESIGNER: PAT SLOAN (PATSLOAN.COM)



In each 2016 issue of *American Patchwork & Quilting*® magazine, we've provided instructions for one row of a year-long row-quilt adventure. Here's our finale!

Project: Mystery Row Quilt: Row 6 and Finishing Instructions

Materials for Row 6

- ¼ yard each cream circle batik, red sun batik, and aqua swirl batik (blocks)
- ⅛ yard each red circle batik, green batik, and multicolor circle batik (blocks)
- ⅜ yard navy batik (blocks)

Finished quilt: 60½×63½"

Finished Row 6 block: 6×9"

Finished Row 6: 9×60"

Yardages and cutting instructions are based on 42" of usable fabric width.

Measurements include ¼" seam allowances. Sew with right sides together unless otherwise stated.

Press seams in directions indicated by arrows on diagrams. If no direction is specified, press seam toward darker fabric.

Cut Fabrics for Row 6

Cut pieces in the following order.

From cream circle batik, cut:

- 10—3⅞" squares

From red circle batik, cut:

- 4—3⅞" squares

From navy batik, cut:

- 3—3⅞" squares
- 8—2½×6½" rectangles
- 3—2½×4½" rectangles
- 4—2½" squares

From green batik, cut:

- 3—3⅞" squares
- 3—2½×4½" rectangles

From multicolor circle batik, cut:

- 4—2½×4½" rectangles

From each red sun batik and aqua swirl batik, cut:

- 6—2½×6½" rectangles
- 3—2½" squares

From light green batik (yardage listed in February issue, Materials for Entire Quilt), cut:

- 7—2½×42" binding strip

Assemble Row 6

1. Use a pencil to mark a diagonal line on wrong side of each cream circle batik 3⅞" square.

2. Layer a marked cream circle batik square atop a red circle batik 3⅞" square. Sew together with two seams, stitching ¼" on each side of drawn line (Diagram 1). Cut pair apart on drawn line and press open to make two red triangle-squares. Each triangle-square should be 3½" square including seam allowances. Repeat to make eight red triangle-squares total.

3. Replacing red circle batik 3⅞" squares with navy batik and green batik 3⅞" squares, repeat Step 2 to make:
 - 6 navy triangle-squares
 - 6 green triangle-squares

4. Referring to Diagram 2, join a navy batik 2½" square and a multicolor circle batik 2½×4½" rectangle. Add navy batik 2½×6½" rectangles to make a house unit.

5. Sew together two red triangle-squares to make a roof unit (Diagram 3). Sew roof unit to house unit to make Block A. The block should be 6½×9½" including seam allowances. Repeat to make four A blocks total.

6. Referring to Diagram 4, repeat steps 4 and 5 using red sun batik 2½×6½" rectangles, red sun batik 2½" squares, green batik 2½×4½" rectangles, and navy triangle-squares to make three B blocks.

7. Referring to Diagram 5, repeat steps 4 and 5 using aqua swirl

batik 2½×6½" rectangles, aqua swirl batik 2½" squares, navy batik 2½×4½" rectangles, and green triangle-squares to make three C blocks.

8. Referring to Quilt Assembly Diagram, sew together blocks A–C to make Row 6. Press seams in one direction.

Complete Quilt

1. Referring to Quilt Assembly Diagram, join all rows to make quilt top. Press seams in one direction.
2. Layer quilt top, batting, and backing; baste.
3. Quilt as desired. Nancy Sharr machine-quilted echoed swirls in an all-over design.
4. Bind with light green batik binding strips.

Project: Mystery Row Quilt: Row 6 and Finishing Instructions



Project: Mystery Row Quilt: Row 6 and Finishing Instructions

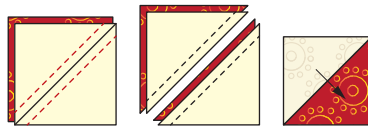
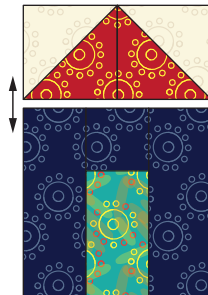

Diagram 1



Diagram 2



Block A
Diagram 3

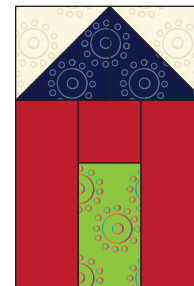

Block B
Diagram 4

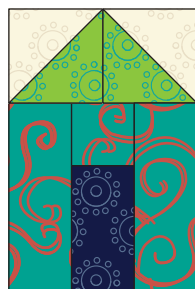

Block C
Diagram 5

Project: Mystery Row Quilt: Row 6 and Finishing Instructions

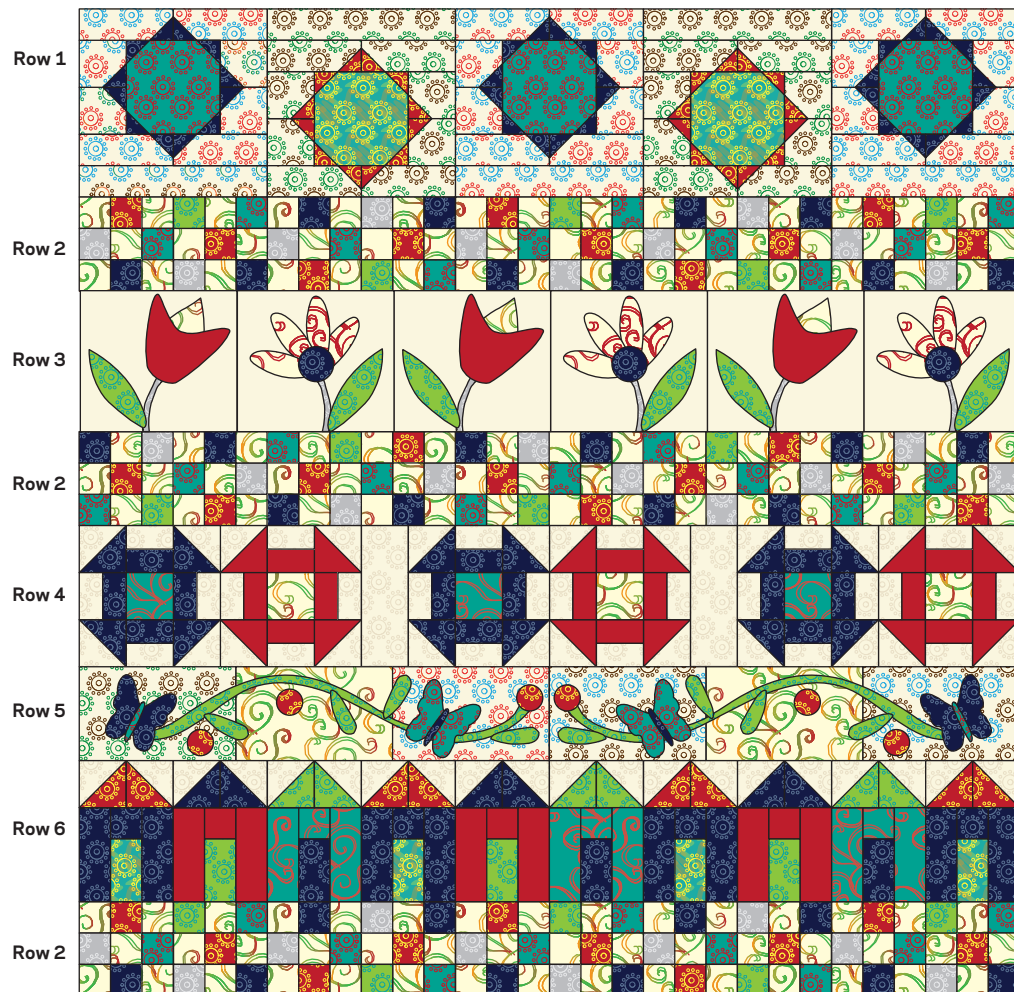

QUILT ASSEMBLY DIAGRAM