

Project: Holiday Double Nine-Patch Quilt

INSPIRED BY URBAN AMISH FROM DESIGNERS CORI DERKSEN AND MYRA HARDER OF BLUE MEADOW DESIGNS (BLUEMEADOWDESIGNS.COM)  
QUILT TESTER: LAURA BOEHNKE

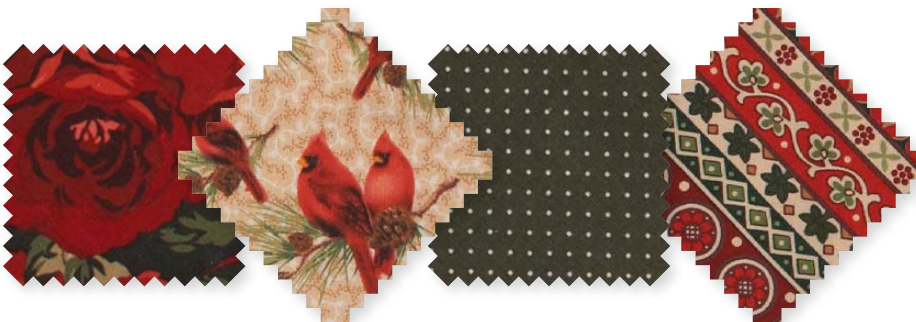
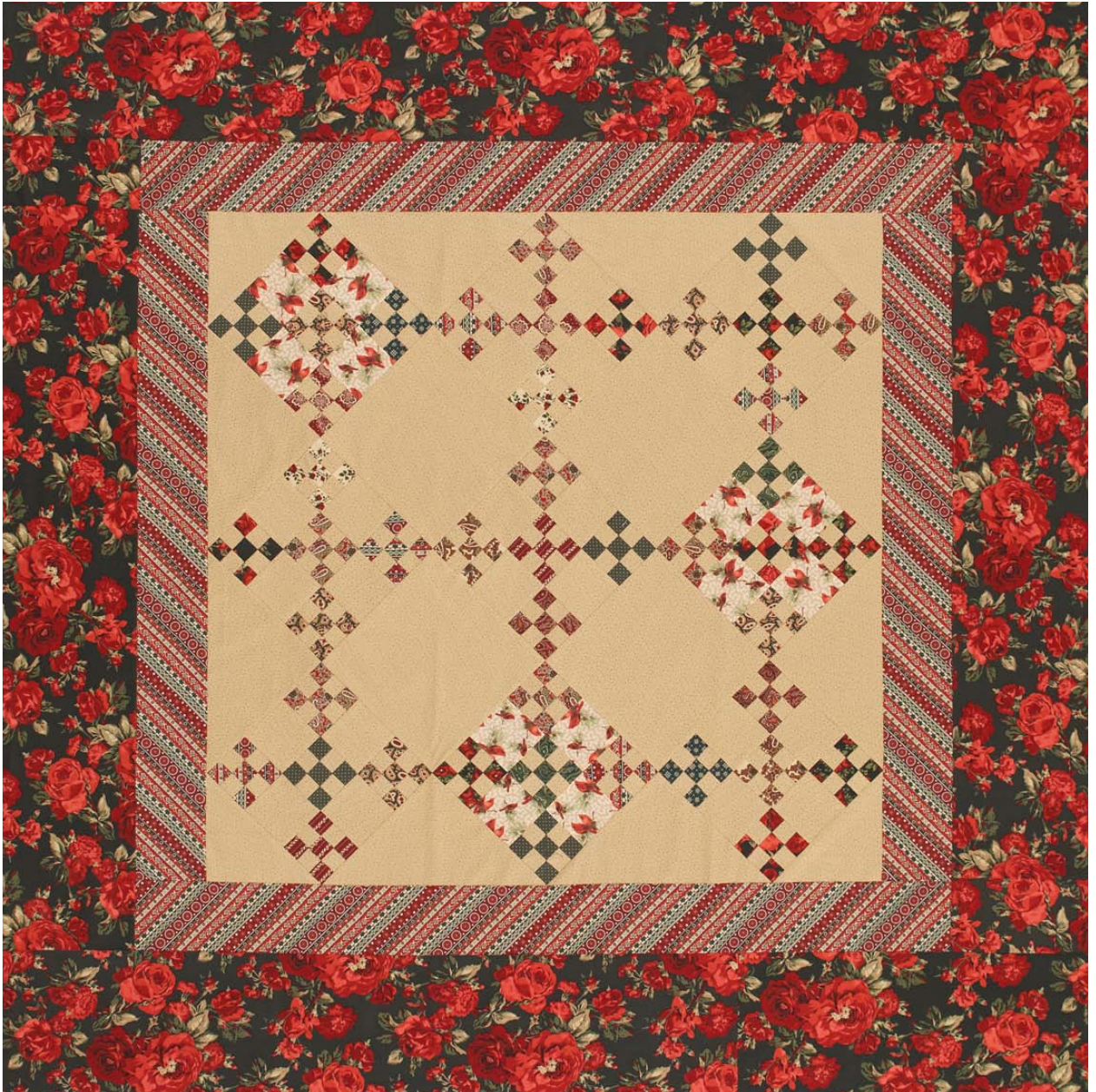

Use holiday prints to give a classic Double Nine-Patch block seasonal flair. Fabrics are from the Holidays at Home collection by Faye Burgos for Marcus Fabrics ([marcusfabrics.com](http://marcusfabrics.com)).

## Project: Holiday Double Nine-Patch Quilt

**Materials**

- ½ yard total assorted green and red prints (blocks)
- 1½ yards tan print (blocks, setting and corner triangles)
- 9×22" piece (fat eighth) red bird print (blocks)
- 1⅓ yards red-and-green stripe (inner border)
- 2 yards red-and-green floral (outer border, binding)
- 4 yards backing fabric
- 71" square batting

**Finished quilt:** 63" square

**Finished blocks:** 9" square

**Quantities** are for 44/45"-wide, 100% cotton fabrics.

**Measurements** include ¼" seam allowances. Sew with right sides together unless otherwise stated.

**Cut Fabrics**

Cut pieces in the following order. Cut inner border strips lengthwise (parallel to the selvages).

**From assorted green and red prints, cut:**

- 225—1½" squares (45 sets of 5 matching squares)

**From tan print, cut:**

- 180—1½" squares
- 2—15" squares, cutting each diagonally twice in an X for 8 setting triangles total
- 4—9½" setting squares
- 2—8" squares, cutting each in half diagonally for 4 corner triangles total
- 24—3½" squares

**From red bird print, cut:**

- 12—3½" squares

**From red-and-green stripe, cut:**

- 2—4½×47" inner border strips
- 2—4½×39" inner border strips

**From red-and-green floral, cut:**

- 6—8½×42" strips for outer border
- 7—2½×42" binding strips

**Assemble Nine-Patch Units**

1. Lay out one set of green or red print 1½" squares and four tan print 1½" squares in three rows (**Diagram 1**).
2. Sew together squares in each row. Press seams toward green or red print.
3. Join rows to make a Nine-Patch unit. Press seams in one direction. The unit should be 3½" square including seam allowances. Repeat to make 45 Nine-Patch units total.

**Assemble Blocks**

1. Referring to **Diagram 2**, sew together five Nine-Patch units and four red bird print 3½" squares in three rows. Press seams toward squares. Join rows to make a dark Double Nine-Patch block. Press seams in one direction. The block should be 9½" square including seam allowances. Repeat to make three dark Double Nine-Patch blocks total.
2. Using tan print 3½" squares instead of red bird print, repeat Step 1 to make a light Double Nine-Patch block (**Diagram 3**). Repeat to make six light Double Nine-Patch blocks total.

**Assemble Quilt Center**

1. Referring to **Quilt Assembly Diagram**, lay out light and dark Double Nine-Patch blocks, setting squares, and setting triangles in five diagonal rows.
2. Sew together pieces in each row. Press seams toward setting squares and triangles.

3. Join rows; press seams in one direction. Add corner triangles to make quilt center. Trim quilt center to 39" including seam allowances.

**Add Borders**

1. Sew red-and-green stripe 4½×39" inner border strips to opposite edges of quilt center. Add red-and-green stripe 4½×47" inner border strips to remaining edges. Press all seams toward inner border.
2. Cut and piece red-and-green floral 8½×42" strips to make:
  - 2—8½×63" outer border strips
  - 2—8½×47" outer border strips
3. Sew short red-and-green floral outer border strips to opposite edges of quilt center. Add long red-and-green floral outer border strips to remaining edges to complete quilt top. Press all seams toward outer border.

**Finish Quilt**

1. Layer quilt top, batting, and backing; baste.
2. Quilt as desired.
3. Bind with red-and-green floral binding strips.

Project: Holiday Double Nine-Patch Quilt



DIAGRAM 1

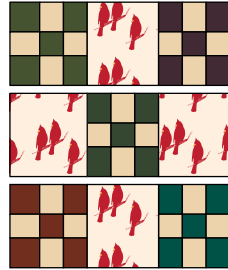

DIAGRAM 2

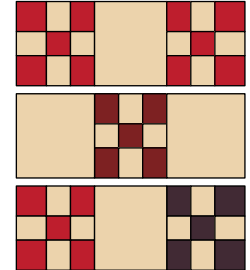
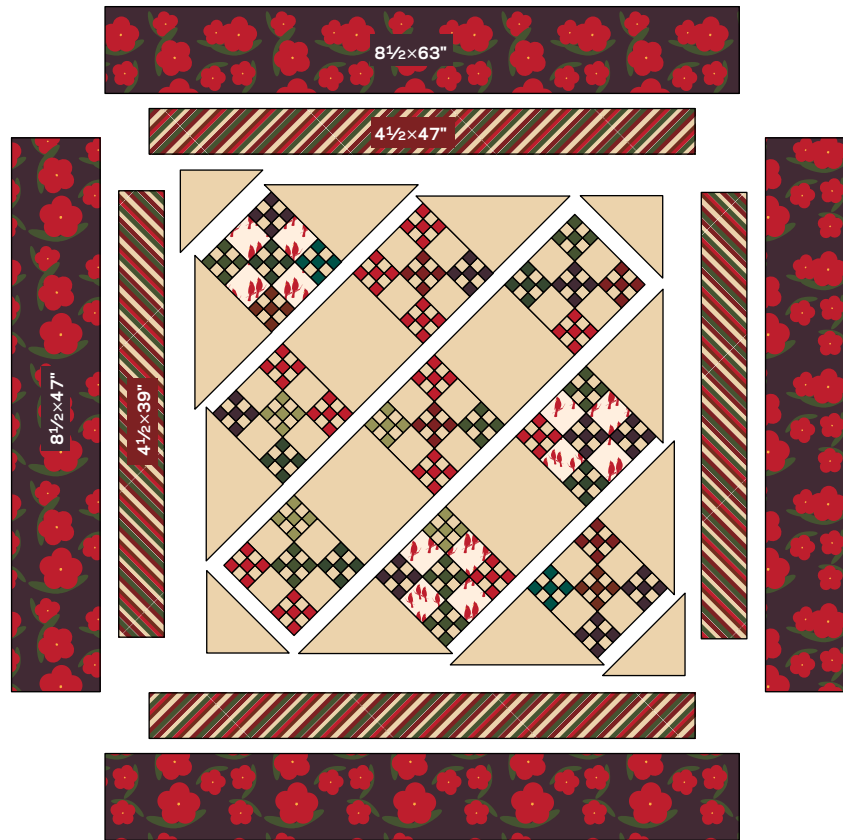

DIAGRAM 3



QUILT ASSEMBLY DIAGRAM