

## Blast from the Past Sampler: Block 7

From *Twilight* by designer Leslie Beck

*American Patchwork & Quilting* magazine June 2000

**FINISHED BLOCK: 9" square**

### MATERIALS

Yardages and cutting instructions are based on 42" of usable fabric width.

- 5" square medium print No. 1
- 9×21" (fat eighth) piece light print
- 5" square medium print No. 2
- 10" square dark print

### CUT FABRICS

Cut pieces in the following order.

If you prefer to make triangle-squares larger than necessary and trim them to size, cut  $2\frac{1}{2}$ " squares instead of the  $2\frac{3}{8}$ " squares specified here.

#### From medium print No. 1, cut:

- 4- $2\frac{3}{8}$ " squares, cutting each in half diagonally for 8 triangles total

#### From light print, cut:

- 4- $2\frac{3}{8}$ " squares
- 4- $2\times 3\frac{1}{2}$ " rectangles
- 8-2" squares

#### From medium print No. 2, cut:

- 1- $4\frac{3}{4}$ " square

#### From dark print, cut:

- 4- $2\frac{3}{8}$ " squares
- 8-2" squares

### ASSEMBLE BLOCK

Measurements include  $\frac{1}{4}$ " seam allowances. Sew with right sides together unless otherwise stated.

Press seams in directions indicated by arrows on diagrams. If no direction is specified, press seam toward darker fabric.

**1** Referring to **Diagram 1**, sew together a  $\frac{1}{2}$ " medium print triangle and a light print 2" square. Add a second medium print triangle to make a corner unit. Repeat to make four corner units total.

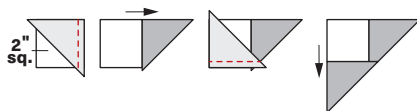

Diagram 1

**2** Referring to **Diagram 2**, sew corner units to opposite edges of a medium print  $4\frac{3}{4}$ " square. Add remaining corner units to remaining edges to make center unit. The unit should be  $6\frac{1}{2}$ " square including seam allowances.

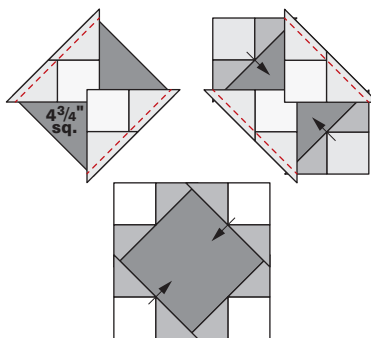

Diagram 2

**3** Use a pencil to mark a diagonal line  $\frac{1}{2}$ " on wrong side of each light print  $2\frac{3}{8}$ " square and dark print 2" square.

**4** Referring to **Diagram 3**, layer a marked light print square atop a dark print  $2\frac{3}{8}$ " square. Sew together with two seams, stitching  $\frac{1}{4}$ " on each side of marked line. Cut apart on marked line. Press open to make two triangle-squares. Each triangle-square should be 2" square including seam allowances. Repeat to make eight triangle-squares total.

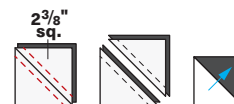

Diagram 3

**5** Referring to **Diagram 4**, align a marked dark print square with one end of a light print  $2\times 3\frac{1}{2}$ " rectangle. Sew on marked line. Trim seam allowance to  $\frac{1}{4}$ ". Press open attached triangle. Add a marked dark print 2" square to opposite end of rectangle to make a Flying Geese unit. The unit still should be  $2\times 3\frac{1}{2}$ " including seam allowances. Repeat to make four Flying Geese units total.

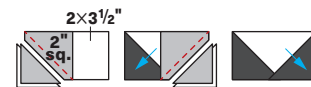

Diagram 4

**6** Referring to **Diagram 5**, sew together two triangle-squares and one Flying Geese unit to make a side unit. The unit should be  $2\times 6\frac{1}{2}$ " including seam allowances. Repeat to make four side units total.



Diagram 5



**7** Referring to **Diagram 6**, lay out remaining light print 2" squares, side units, and center unit in three rows. Sew together pieces in rows. Join rows to make a block. The block should be 9½" square including seam allowances.

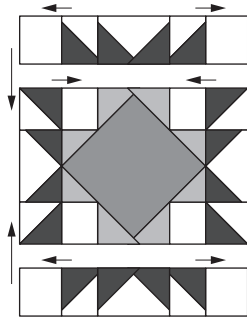

**Diagram 6**

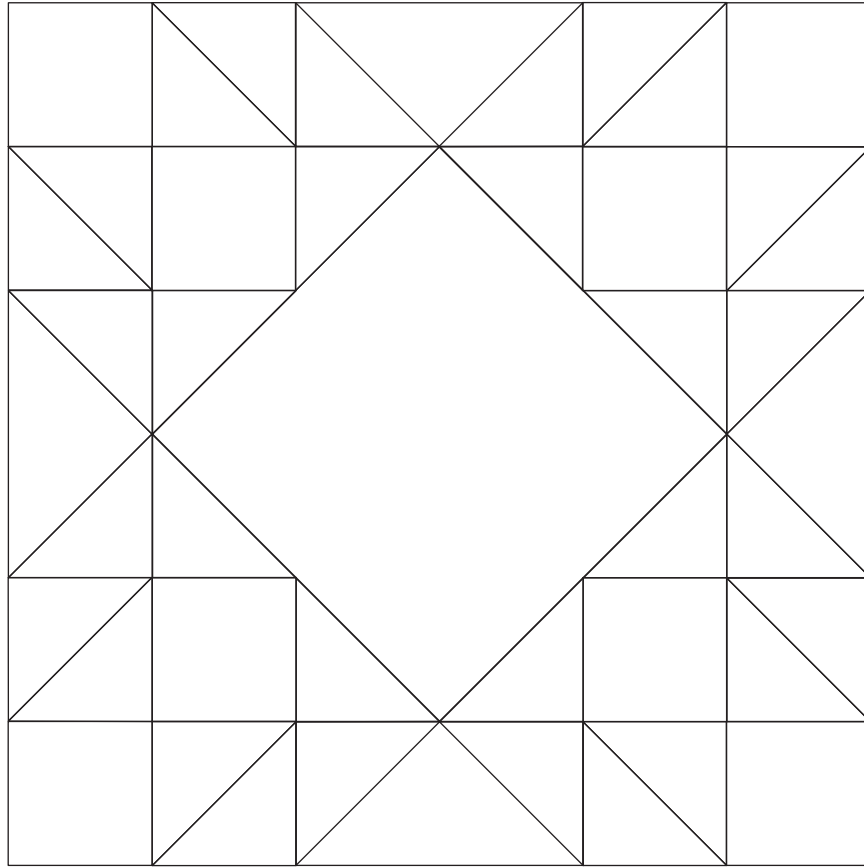

Coloring Diagram

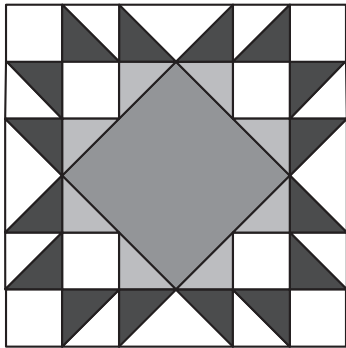

Use the Coloring Diagram, *top*, to plan your version of the original block, *above*. Audition fabric swatches using the squares, *right*.

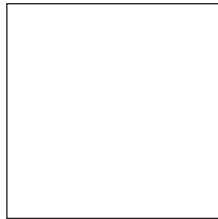

Swatch

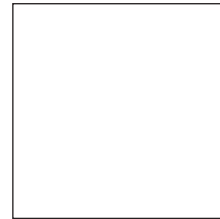

Swatch

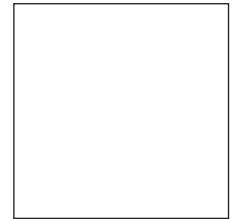

Swatch

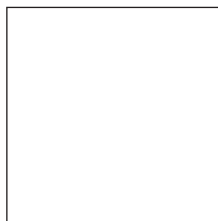

Swatch

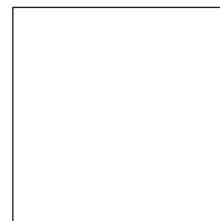

Swatch

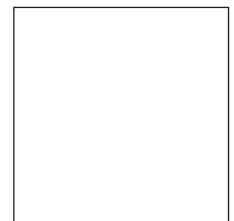

Swatch